

Notes:-

1. Junction design based on TD 42/95 Geometric Design of Major/Minor Priority Junctions and TD 50/04 The Geometric Layout of Signal Controlled Junctions and Signalised Roundabouts.
2. All road markings compliant with TSRGD 2016 and Chapter 5 of the Traffic Signs Manual

Disclaimers:-

- i. This drawing is copyright and must not be copied in part or in whole unless agreed in writing by Local Transport Projects Ltd
- ii. Reference should be made to the project's drawing register to ensure the latest drawing is being referred to.
- iii. All dimensions are to be checked by the contractor prior to commencement of work. Any discrepancy shall be reported immediately to Local Transport Projects Ltd
- iv. All work shall be carried out in accordance with local authority, statutory authority and health & safety requirements & regulations
- v. Topographical Survey information supplied by Greenhatch Groups Ltd 2017.

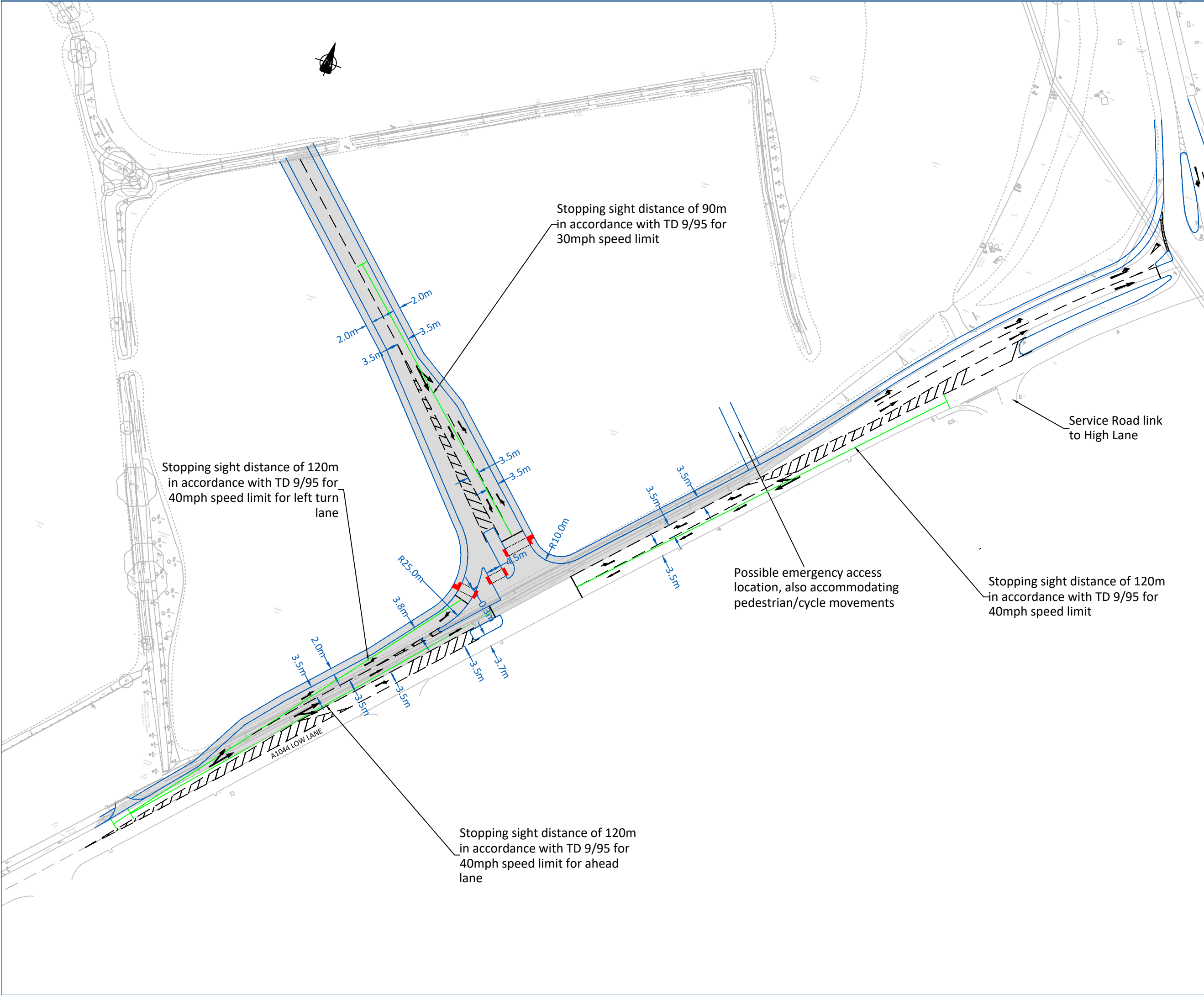

Rev.	Date	By	Chk	Description
B	20 05 19	CW	JH	Right turn facility added to south west of proposed signalised junction.
A	20 04 18	CW	SW	Junction layout amended to increase capacity by introducing left filter for north eastbound traffic. Vis Splays added to drawing.

Client
Mr & Mrs Snowdon

Project
**Proposed Mixed-Use Development
Low Lane, Ingleby Barwick**

Title
**Potential Traffic Signal Junction
A1044 Low Lane
Including Visibility Splays**



INSTITUTE OF HIGHWAY ENGINEERS
 25 000
 Armstrong House,
 The Flemingate Centre,
 Armstrong Way, Beverley,
 HU17 0NZ.
 01482 679 911
 info@local-transport-projects.co.uk
 www.local-transport-projects.co.uk
 Registered No. 5295328

Drawn	CW	Date	06 04 18
Scale	1 : 1000	Checked	SW

Status	<input type="checkbox"/> INTERNAL DRAFT	<input type="checkbox"/> PRELIMINARY
	<input checked="" type="checkbox"/> DRAFT	<input type="checkbox"/> CONSTRUCTION
	<input type="checkbox"/> APPROVED	<input type="checkbox"/> AS BUILT

Drawing number				
Project	Job	Drawing	Sheet	Revision
LTP/2691/TS/06	01			B